

7276B.MP

Angular Contact Ball Bearings (single row, metric)



Details:

Main dimensions

d [mm]	380	D_1 [mm]	≈ 564.5
D [mm]	680	$r_{1,2}$ [mm]	6
B [mm]	95	$r_{3,4}$ [mm]	3
Weight [kg]	≈ 157	α_0 [°]	40
d_1 [mm]	≈ 502.8	a [mm]	≈ 270

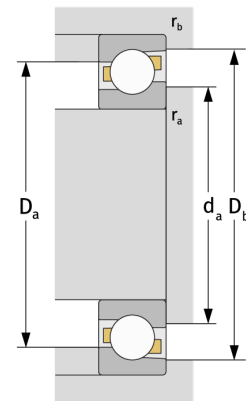
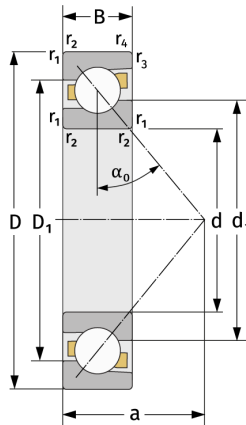

Mating dimensions

$d_{a, \min}$ [mm]	406
$D_{a, \max}$ [mm]	654
$D_{b, \max}$ [mm]	666
$r_{a, \max}$ [mm]	5
$r_{b, \max}$ [mm]	2.5

Calculation data

C [kN]	685
C_0 [kN]	1360
C_u [kN]	29.2
n_{th} [min ⁻¹]	894
n_g [min ⁻¹]	1200