

7280B.MP

Angular Contact Ball Bearings (single row, metric)



Details:

Main dimensions

d [mm]	400	D_1 [mm]	≈ 597.4
D [mm]	720	$r_{1,2}$ [mm]	6
B [mm]	103	$r_{3,4}$ [mm]	3
Weight [kg]	≈ 191	α_0 [°]	40
d_1 [mm]	≈ 530.5	a [mm]	≈ 286

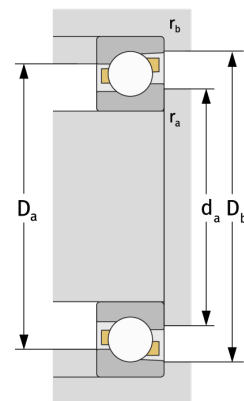
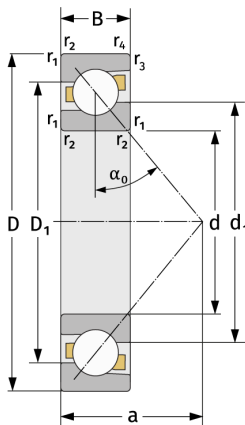

Mating dimensions		Calculation data	
$d_{a, \min}$ [mm]	426	C [kN]	775
$D_{a, \max}$ [mm]	694	C_0 [kN]	1590
$D_{b, \max}$ [mm]	706	C_u [kN]	33.2
$r_{a, \max}$ [mm]	5	n_{th} [min ⁻¹]	830
$r_{b, \max}$ [mm]	2.5	n_g [min ⁻¹]	1100