

7368B.MP

Angular Contact Ball Bearings (single row, metric)



Details:

Main dimensions

d [mm]	340	D_1 [mm]	≈ 569.6
D [mm]	710	$r_{1,2}$ [mm]	7.5
B [mm]	118	$r_{3,4}$ [mm]	4
Weight [kg]	≈ 239	α_0 [°]	40
d_1 [mm]	≈ 489.8	a [mm]	≈ 279

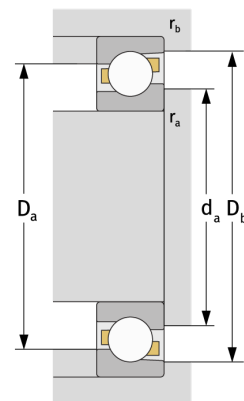
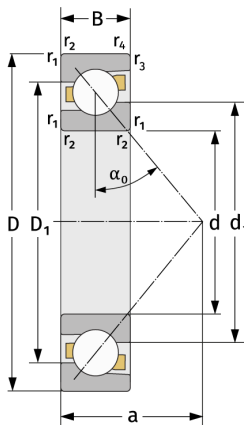

Mating dimensions		Calculation data	
$d_{a, \min}$ [mm]	372	C [kN]	885
$D_{a, \max}$ [mm]	678	C_0 [kN]	1710
$D_{b, \max}$ [mm]	693	C_u [kN]	36.8
$r_{a, \max}$ [mm]	6	n_{th} [min ⁻¹]	792
$r_{b, \max}$ [mm]	3	n_g [min ⁻¹]	1200