

# AH30/630A

Withdrawal Sleeves



## Details:

### Main dimensions

d [mm]	630	G [mm]	Tr670x6
Weight [kg]	≈ 87.8		
d <sub>1</sub> [mm]	600	G <sub>1</sub> [mm]	G1/4
B <sub>1</sub> [mm]	258	l <sub>G1</sub> [mm]	15
l <sub>G1</sub> [mm]	46	a [mm]	9

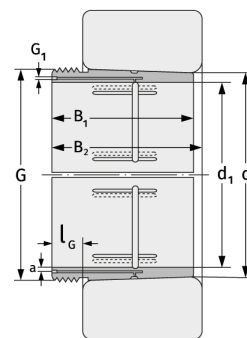

### Mating dimensions

### Calculation data