

AH3072G

Withdrawal Sleeves



Details:

Main dimensions

d [mm]	360	G [mm]	Tr380x5
Weight [kg]	≈ 20.5		
d ₁ [mm]	340	G ₁ [mm]	G1/4
B ₁ [mm]	167	l _{G1} [mm]	15
l _{G1} [mm]	30	a [mm]	9

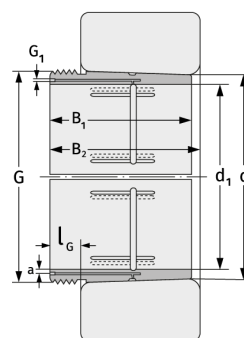

Mating dimensions

Calculation data