

# AH31/1000A

Withdrawal Sleeves

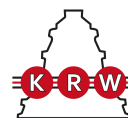

## Details:

### Main dimensions

d [mm]	1000	G [mm]	Tr1060
Weight [kg]	≈ 482		x8
d <sub>1</sub> [mm]	950	G <sub>1</sub> [mm]	G1/4
B <sub>1</sub> [mm]	525	l <sub>G1</sub> [mm]	15
l <sub>G1</sub> [mm]	63	a [mm]	9

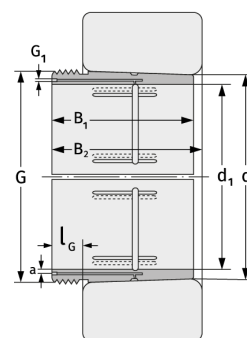

### Mating dimensions

### Calculation data