

AH32/530G

Withdrawal Sleeves



Details:

Main dimensions

d [mm]	530	G [mm]	Tr560x6
Weight [kg]	≈ 124		
d ₁ [mm]	500	G ₁ [mm]	G1/4
B ₁ [mm]	412	l _{G1} [mm]	15
l _{G1} [mm]	57	a [mm]	9

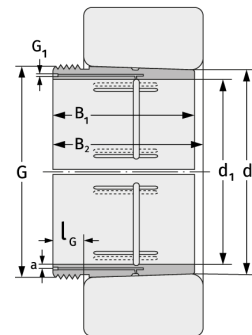

Mating dimensions

Calculation data