

# AH32/800A.G

Withdrawal Sleeves



## Details:

### Main dimensions

d [mm]	800	G [mm]	Tr850x7
Weight [kg]	≈ 403		
d <sub>1</sub> [mm]	750	G <sub>1</sub> [mm]	G1/4
B <sub>1</sub> [mm]	555	l <sub>G1</sub> [mm]	15
l <sub>G1</sub> [mm]	62	a [mm]	9

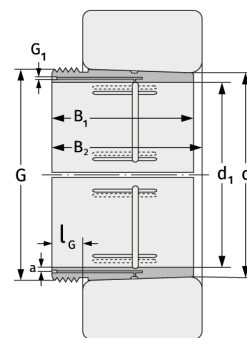

### Mating dimensions

### Calculation data