

AH3276G

Withdrawal Sleeves



Details:

Main dimensions

d [mm]	380	G [mm]	Tr400x5
Weight [kg]	≈ 41.3		
d ₁ [mm]	360	G ₁ [mm]	G1/4
B ₁ [mm]	284	l _{G1} [mm]	15
l _{G1} [mm]	42	a [mm]	9

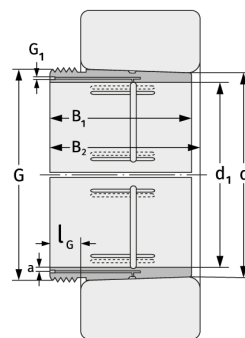

Mating dimensions

Calculation data