

AH3284

Withdrawal Sleeves



Details:

Main dimensions

d [mm]	420	G [mm]	Tr460x5
Weight [kg]	≈ 58.9		
d ₁ [mm]	400	G ₁ [mm]	G1/4
B ₁ [mm]	321	l _{G1} [mm]	15
l _{G1} [mm]	46	a [mm]	9

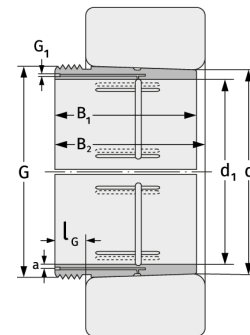

Mating dimensions

Calculation data