

# AH39/670G

Withdrawal Sleeves



## Details:

### Main dimensions

d [mm]	670	G [mm]	Tr710x7
Weight [kg]	≈ 92.9		
d <sub>1</sub> [mm]	630	G <sub>1</sub> [mm]	G1/4
B <sub>1</sub> [mm]	216	l <sub>G1</sub> [mm]	15
l <sub>G1</sub> [mm]	41	a [mm]	9

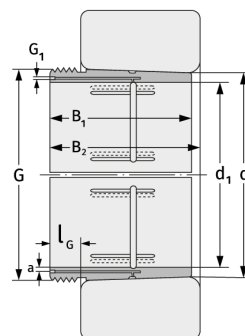

### Mating dimensions

### Calculation data