

H2309

Clamping Sleeves



Details:

Main dimensions

d [mm]	45	B ₁ [mm]	50
Weight [kg]	≈ 0.28	B ₂ [mm]	11
d ₁ [mm]	40	G [mm]	M45x1.
d ₂ [mm]	65		5

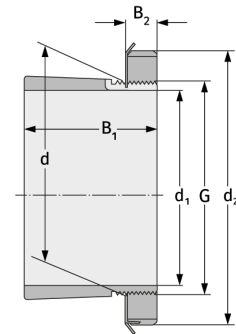

Mating dimensions

Containing components

Groove / shaft nut	KM9
Securing	MB9