

# H2317

Clamping Sleeves



## Details:

### Main dimensions

d [mm]	85	B <sub>1</sub> [mm]	82
Weight [kg]	≈ 1.45	B <sub>2</sub> [mm]	18
d <sub>1</sub> [mm]	75	G [mm]	M85x2
d <sub>2</sub> [mm]	110		

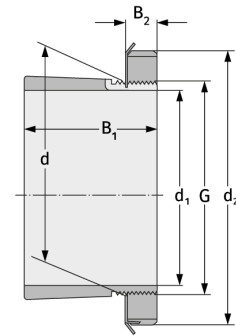

### Mating dimensions

### Containing components

Groove / shaft nut	KM17
Securing	MB17