

Q217MPB

Four Point Contact Ball Bearings (metric)



Details:

Main dimensions

d [mm]	85	D_1 [mm]	≈ 127.2
D [mm]	150	$r_{1,2}$ [mm]	2
B [mm]	28	α_0 [°]	23
Weight [kg]	≈ 2.35	a [mm]	≈ 50
d_1 [mm]	≈ 107.8		

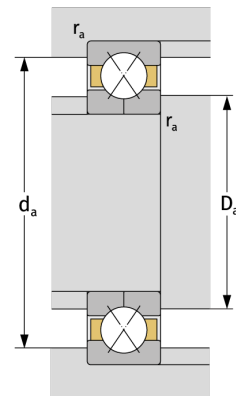
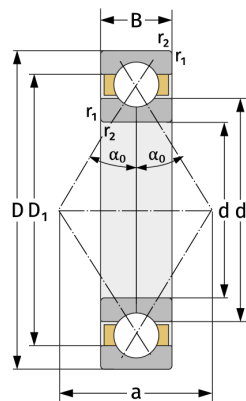

Mating dimensions

$d_{a, \min}$ [mm]	96
$D_{a, \max}$ [mm]	139
$r_{a, \max}$ [mm]	2

Calculation data

C [kN]	166
C_0 [kN]	175
C_u [kN]	7.82
n_{th} [min ⁻¹]	3936
n_g [min ⁻¹]	7400