

QJ1256MPA

Four Point Contact Ball Bearings (metric)



Details:

Main dimensions

d [mm]	280	D_1 [mm]	≈ 416
D [mm]	500	$r_{1,2}$ [mm]	5
B [mm]	90	α_0 [°]	45
Weight [kg]	≈ 86.6	a [mm]	≈ 390
d_1 [mm]	≈ 364		

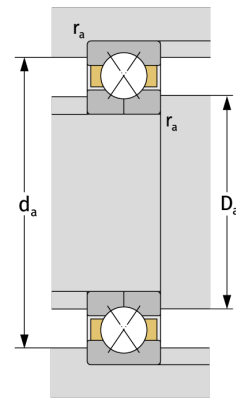
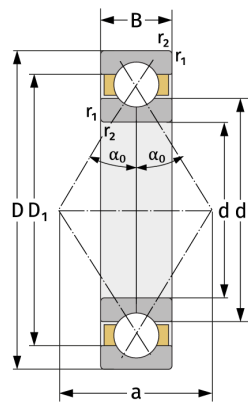

Mating dimensions

$d_{a, \min}$ [mm]	300
$D_{a, \max}$ [mm]	480
$r_{a, \max}$ [mm]	4

Calculation data

C [kN]	735
C_0 [kN]	1460
C_u [kN]	36.7
n_{th} [min ⁻¹]	1169
n_g [min ⁻¹]	2100