

QJ1276MPA

Four Point Contact Ball Bearings (metric)



Details:

Main dimensions

d [mm]	380	D_1 [mm]	≈ 566.4
D [mm]	680	$r_{1,2}$ [mm]	6
B [mm]	132	α_0 [°]	45
Weight [kg]	≈ 233	a [mm]	≈ 530
d_1 [mm]	≈ 493.6		

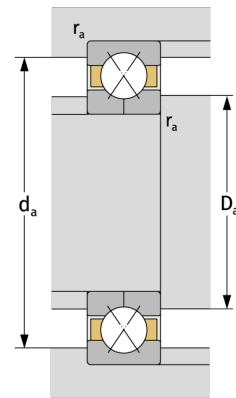
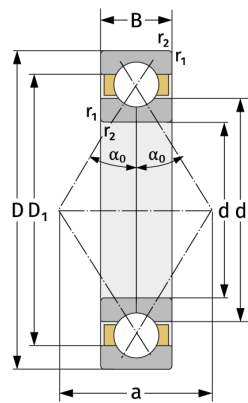

Mating dimensions

$d_{a, \min}$ [mm]	406
$D_{a, \max}$ [mm]	654
$r_{a, \max}$ [mm]	5

Calculation data

C [kN]	1190
C_0 [kN]	2840
C_u [kN]	61.8
n_{th} [min ⁻¹]	781
n_g [min ⁻¹]	1500