

QJ1284MPA

Four Point Contact Ball Bearings (metric)



Details:

Main dimensions

d [mm]	420	D_1 [mm]	≈ 631.6
D [mm]	760	$r_{1,2}$ [mm]	7.5
B [mm]	150	α_0 [°]	45
Weight [kg]	≈ 335	a [mm]	≈ 590
d_1 [mm]	≈ 548.4		

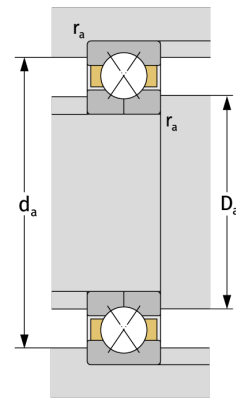
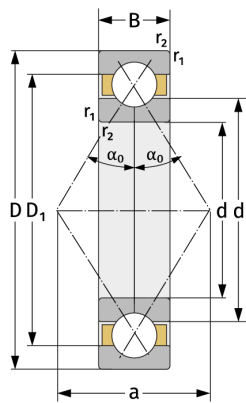

Mating dimensions

$d_{a, \min}$ [mm]	452
$D_{a, \max}$ [mm]	728
$r_{a, \max}$ [mm]	6

Calculation data

C [kN]	1440
C_0 [kN]	3700
C_u [kN]	76.4
n_{th} [min ⁻¹]	661
n_g [min ⁻¹]	1300