

QJ19/530MPA

Four Point Contact Ball Bearings (metric)



Details:

Main dimensions

d [mm]	530	D_1 [mm]	≈ 647.8
D [mm]	710	$r_{1,2}$ [mm]	5
B [mm]	82	α_0 [°]	35
Weight [kg]	≈ 99.5	a [mm]	≈ 434
d_1 [mm]	≈ 592.2		

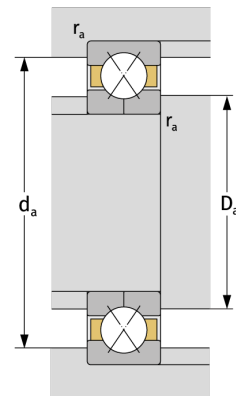
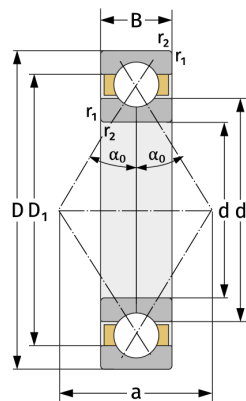

Mating dimensions

$d_{a, \min}$ [mm]	548
$D_{a, \max}$ [mm]	692
$r_{a, \max}$ [mm]	4

Calculation data

C [kN]	940
C_0 [kN]	2520
C_u [kN]	50.8
n_{th} [min ⁻¹]	566
n_g [min ⁻¹]	1200