

# QJ234MPA

Four Point Contact Ball Bearings (metric)



## Details:

### Main dimensions

d [mm]	170	$D_1$ [mm]	$\approx 258.6$
D [mm]	310	$r_{1,2}$ [mm]	4
B [mm]	52	$\alpha_0$ [°]	35
Weight [kg]	$\approx 19.5$	a [mm]	$\approx 168$
$d_1$ [mm]	$\approx 221.4$		

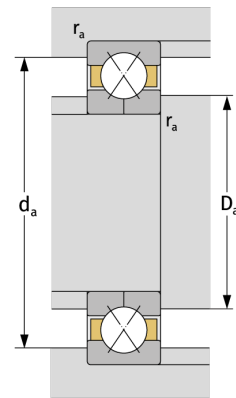
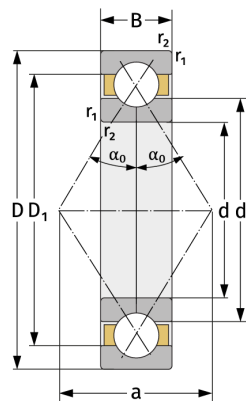

### Mating dimensions

$d_{a, \min}$ [mm]	187
$D_{a, \max}$ [mm]	293
$r_{a, \max}$ [mm]	3

### Calculation data

C [kN]	426
$C_0$ [kN]	635
$C_u$ [kN]	20.1
$n_{th}$ [min <sup>-1</sup> ]	2011
$n_g$ [min <sup>-1</sup> ]	3500