

QJ296MPA

Four Point Contact Ball Bearings (metric)



Details:

Main dimensions

d [mm]	480	D_1 [mm]	≈ 721.4
D [mm]	870	$r_{1,2}$ [mm]	7.5
B [mm]	125	α_0 [°]	35
Weight [kg]	≈ 374	a [mm]	≈ 473
d_1 [mm]	≈ 628.6		

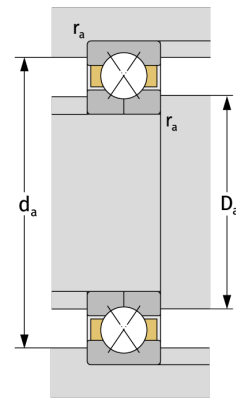
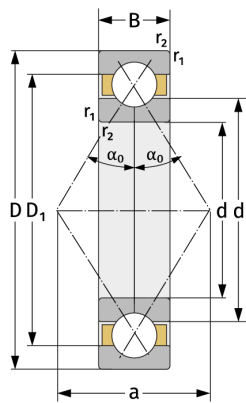

Mating dimensions

$d_{a, \min}$ [mm]	512
$D_{a, \max}$ [mm]	838
$r_{a, \max}$ [mm]	6

Calculation data

C [kN]	1620
C_0 [kN]	4510
C_u [kN]	87.3
n_{th} [min ⁻¹]	478
n_g [min ⁻¹]	1100