

# QJ320MPA

Four Point Contact Ball Bearings (metric)



## Details:

### Main dimensions

d [mm]	100	$D_1$ [mm]	$\approx 175.3$
D [mm]	215	$r_{1,2}$ [mm]	3
B [mm]	47	$\alpha_0$ [°]	35
Weight [kg]	$\approx 9.51$	a [mm]	$\approx 110$
$d_1$ [mm]	$\approx 139.7$		

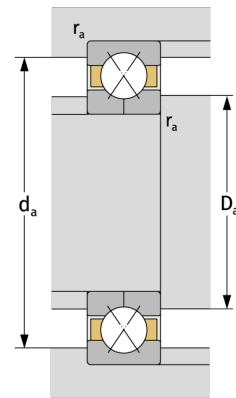

### Mating dimensions

$d_{a, \min}$ [mm]	114
$D_{a, \max}$ [mm]	201
$r_{a, \max}$ [mm]	2.5

### Calculation data

C [kN]	334
$C_0$ [kN]	373
$C_u$ [kN]	14.5
$n_{th}$ [min <sup>-1</sup> ]	3005
$n_g$ [min <sup>-1</sup> ]	5500