

QJ328MPA

Four Point Contact Ball Bearings (metric)



Details:

Main dimensions

d [mm]	140	D_1 [mm]	≈ 243.2
D [mm]	300	$r_{1,2}$ [mm]	4
B [mm]	62	α_0 [°]	35
Weight [kg]	≈ 24.4	a [mm]	≈ 154
d_1 [mm]	≈ 196.8		

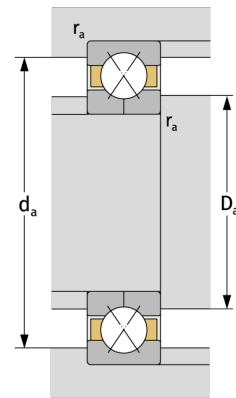

Mating dimensions

$d_{a, \min}$ [mm]	157
$D_{a, \max}$ [mm]	283
$r_{a, \max}$ [mm]	3

Calculation data

C [kN]	482
C_0 [kN]	650
C_u [kN]	21.5
n_{th} [min ⁻¹]	2045
n_g [min ⁻¹]	3900