

QJ396MPA

Four Point Contact Ball Bearings (metric)



Details:

Main dimensions

d [mm]	480	D_1 [mm]	≈ 793.3
D [mm]	980	$r_{1,2}$ [mm]	9.5
B [mm]	160	α_0 [°]	35
Weight [kg]	≈ 669	a [mm]	≈ 511
d_1 [mm]	≈ 666.7		

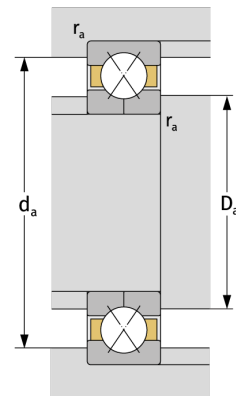
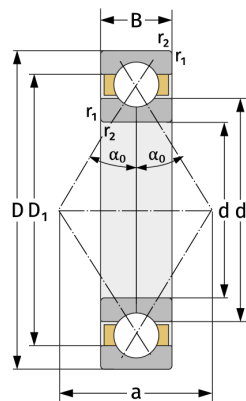

Mating dimensions

$d_{a, \min}$ [mm]	520
$D_{a, \max}$ [mm]	940
$r_{a, \max}$ [mm]	8

Calculation data

C [kN]	2230
C_0 [kN]	6350
C_u [kN]	118
n_{th} [min ⁻¹]	382
n_g [min ⁻¹]	970