

QJ428MPA

Four Point Contact Ball Bearings (metric)



Details:

Main dimensions

d [mm]	140	D_1 [mm]	≈ 280.9
D [mm]	360	$r_{1,2}$ [mm]	5
B [mm]	82	α_0 [°]	35
Weight [kg]	≈ 50.5	a [mm]	≈ 175
d_1 [mm]	≈ 219.1		

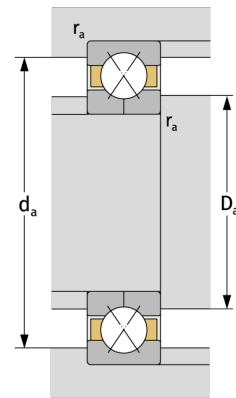
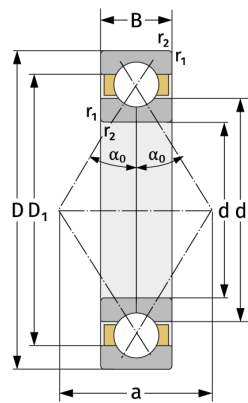

Mating dimensions

$d_{a, \min}$ [mm]	164
$D_{a, \max}$ [mm]	336
$r_{a, \max}$ [mm]	4

Calculation data

C [kN]	645
C_0 [kN]	915
C_u [kN]	28.5
n_{th} [min ⁻¹]	1630
n_g [min ⁻¹]	3400