

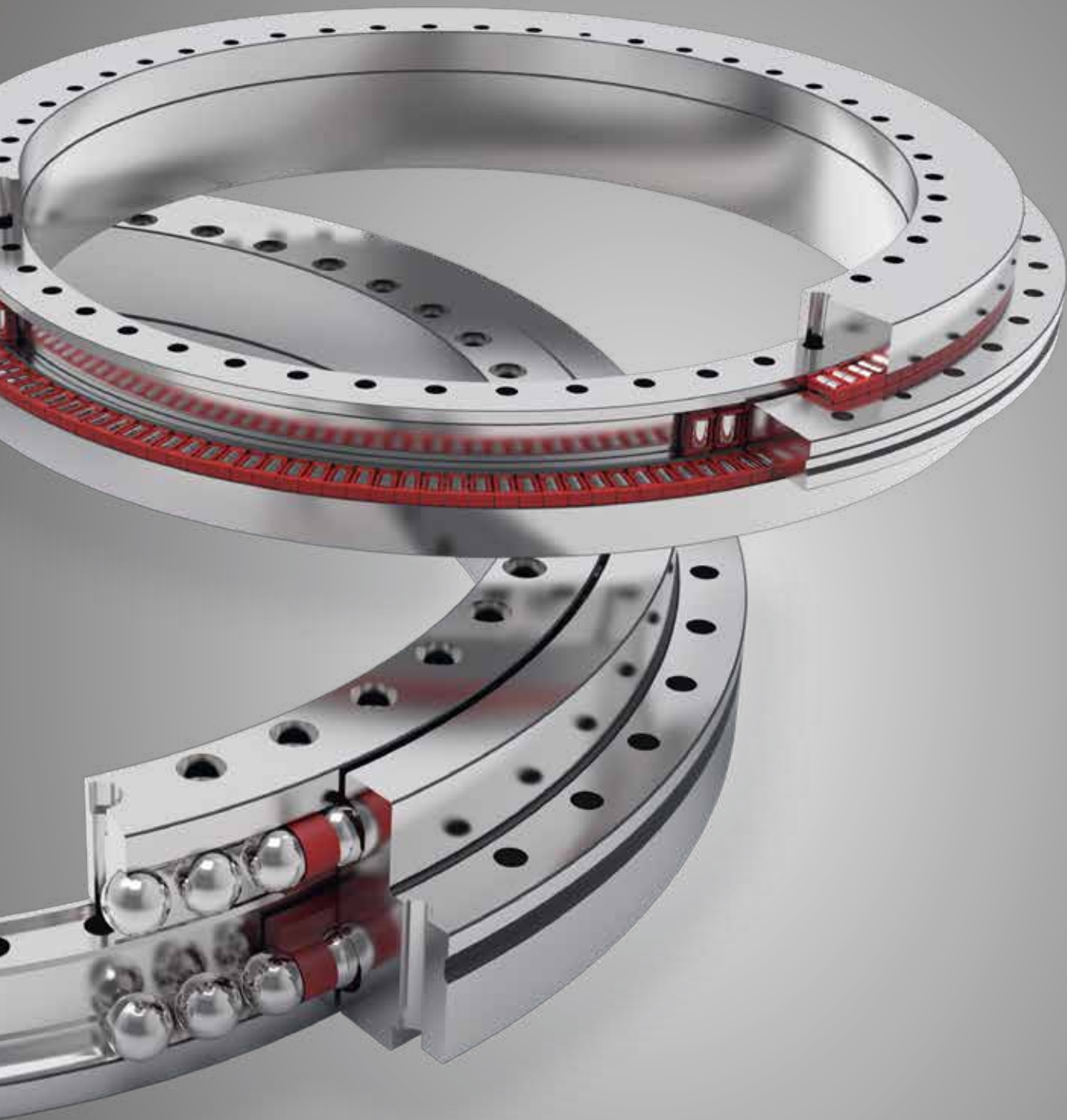

[www.krw.de](http://www.krw.de)



# ROTAB<sup>®</sup>

The new excellence class  
of rotary table bearings

# ROTAB® – The new excellence class of rotary table bearings

Rotary table bearings of KRW ROTAB® series are high precision rolling bearings for the most challenging processing tasks for machine tools. The ready to install, preloaded and greased bearing units support combined axial and radial loads as well as bending moments. With the ROTAB® series KRW offers the first modular and interchangeable single-bearing solution within the segment of large rotary table bearings for heavy milling and high-speed turning.

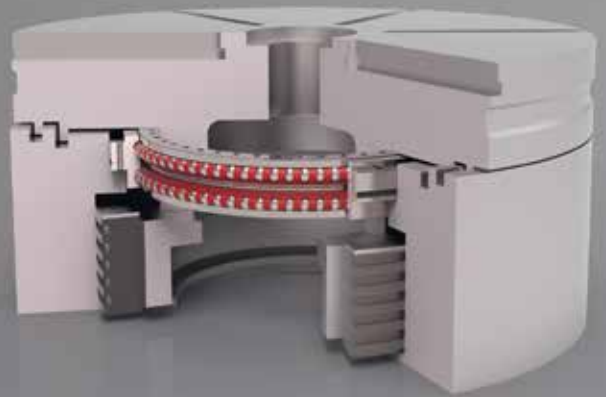

## ROTAB® ARS

The consequent further development of the proven axial-radial bearing combines the high rigidity and load capacity of this bearing type with considerably increased rotational speed. The entirely new developed inner geometry of the ROTAB® ARS combined with a special roller design and super finished surfaces reduces the frictional moment by up to 50% compared to established competing products. Furthermore, the smart cage design reliably prevents lubricating grease loss even at high rotational speeds. This significantly reduces lubricant consumption and improves operational reliability. Associated downtime due to lubrication intervals is considerably reduced.



## ROTAB® DBS

The ROTAB® DBS sets a new standard for high-speed machine tool bearings. The preloaded, double directional ball bearing unit is able to reach extreme speeds and offers sufficient rigidity, even for challenging milling tasks. Thanks to the sophisticated design and the high accuracy of the bearing, the friction moment is significantly reduced compared to a conventional axial-radial bearing. This results in very low self-heating of the system in addition to considerable energy savings during the machine operating time. Therefore a simple to realize grease lubrication is adequate for almost every application. This reduces the costs of the table design as well as the maintenance effort for high-speed rotary tables significantly.



# Application & advantages of the ROTAB® SERIES

Both bearings ROTAB® ARS and ROTAB® DBS are exchangeable with the axial-radial bearings of established manufacturers. Therefore our customers are able to choose a ROTAB® ARS for heavy milling or a ROTAB® DBS for the highest rotational speeds within one bearing size. The modular structure of the KRW ROTAB® series enables an effective reduction of design variety of rotary tables.

The following table presents a selection of our KRW ROTAB® portfolio. The connection dimensions of our standard bearings correspond to those of established axial-radial bearings to assure compatibility. For detailed information and our complete portfolio, please see our ROTAB® catalogue available online at [www.krw.de](http://www.krw.de).

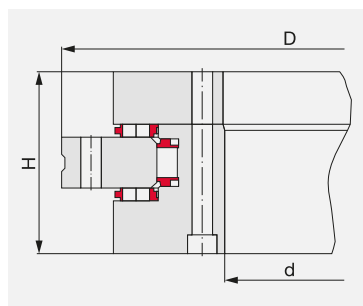

ROTAB® ARS series

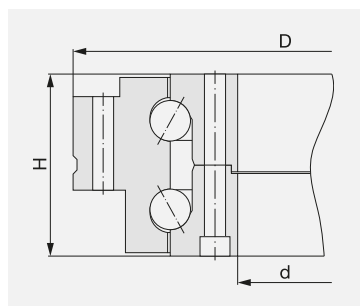

ROTAB® DBS series

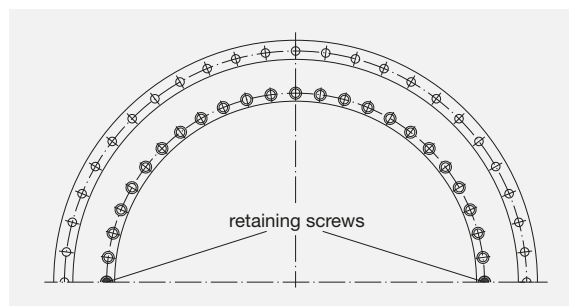

Code	Dimension			Load rating				Maximum speed	Weight
				axial		radial			
				dyn.	stat.	dyn.	stat.		
	d	D	H	C <sub>a</sub>	C <sub>0a</sub>	C <sub>r</sub>	C <sub>0r</sub>	n <sub>G</sub>	≈
	mm	mm	mm	kN	kN	kN	kN	min <sup>-1</sup>	kg
ROTAB ARS 200	200	300	45	121	990	64	184	670	10
ROTAB ARS 260	260	385	55	139	1280	74	239	510	18
ROTAB ARS 325	325	450	60	153	1540	82	294	420	25
ROTAB ARS 395	395	525	65	167	1830	90	351	350	33
ROTAB ARS 460	460	600	70	182	2140	163	625	300	45
ROTAB ARS 580	580	750	90	387	4340	165	675	230	87
ROTAB ARS 650	650	870	122	505	5850	408	1390	200	166
ROTAB ARS 850	850	1095	124	575	7500	453	1810	150	241
ROTAB ARS 950	950	1200	132	945	12100	494	2010	130	305
ROTAB ARS 1030	1030	1300	145	985	13100	520	2180	120	367
ROTAB DBS 200	200	300	45	115	615	–	–	3100	10
ROTAB DBS 260	260	385	55	154	925	–	–	2300	18
ROTAB DBS 325	325	450	60	163	1110	–	–	1900	25
ROTAB DBS 395	395	525	65	229	1590	–	–	1500	33
ROTAB DBS 460	460	600	70	248	1910	–	–	1300	46
ROTAB DBS 580	580	750	90	332	2850	–	–	940	89
ROTAB DBS 650	650	870	122	535	4430	–	–	810	177
ROTAB DBS 850	850	1095	124	605	5950	–	–	560	248
ROTAB DBS 950	950	1200	132	730	7650	–	–	480	292
ROTAB DBS 1030	1030	1300	145	750	8200	–	–	420	389

For questions about the layout or technical details of our ROTAB® series, please contact our KRW engineering team. Custom solutions to meet special requirements up to “simultaneous engineering” are commonplace for us. Of course we assist you with design and layout of your customized table bearing.

You are missing a size, need to reduce the installation space or a special adaptation? We manufacture your customized ROTAB® bearing for you!

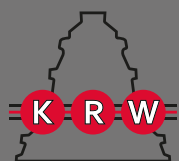

**Kugel- und Rollenlagerwerk  
Leipzig GmbH**

Gutenbergstraße 6  
04178 Leipzig  
Germany

Phone +49 (0) 341 45320-200  
Fax +49 (0) 341 45320-201  
E-mail [sales@krw.de](mailto:sales@krw.de)

[www.krw.de](http://www.krw.de)