

# 60852M

Rillenkugellager (einreihig, metrisch)



## Details:

### Hauptabmessungen

d [mm]	260	d <sub>1</sub> [mm]	≈ 281,6
D [mm]	320	D <sub>1</sub> [mm]	≈ 298,6
B [mm]	19	r <sub>1,2</sub> [mm]	1
Gewicht [kg]	≈ 3,59		

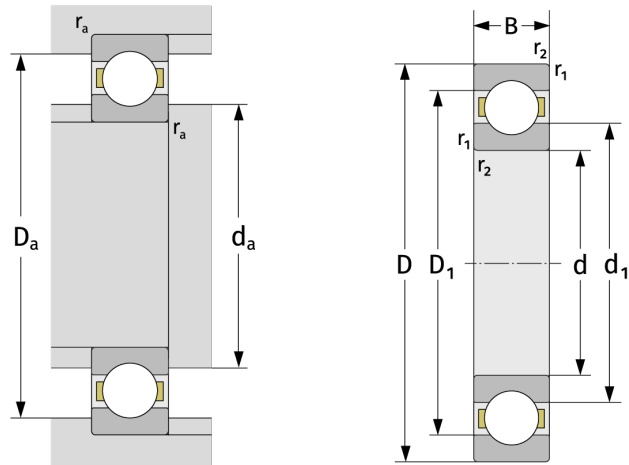

### Anschlussmaße

d <sub>a,min</sub> [mm]	265
D <sub>a,max</sub> [mm]	315
r <sub>a,max</sub> [mm]	1

### Berechnungsdaten

C [kN]	71,6
C <sub>0</sub> [kN]	106
C <sub>u</sub> [kN]	3,11
n <sub>th</sub> [min <sup>-1</sup> ]	1656
n <sub>g</sub> [min <sup>-1</sup> ]	3200
f <sub>0</sub>	15,6