

60930M

Rillenkugellager (einreihig, metrisch)



Details:

Hauptabmessungen

d [mm]	150	d ₁ [mm]	≈ 171,1
D [mm]	210	D ₁ [mm]	≈ 189,1
B [mm]	19	r _{1,2} [mm]	1,1
Gewicht [kg]	≈ 2,24		

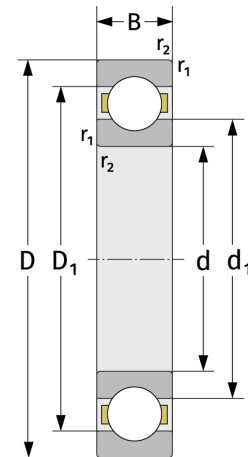
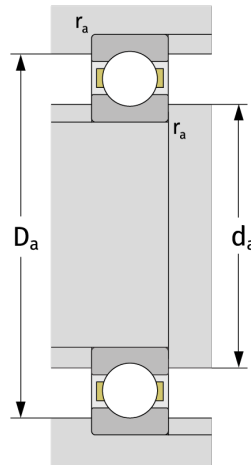

Anschlussmaße

d _{a,min} [mm]	156
D _{a,max} [mm]	204
r _{a,max} [mm]	1

Berechnungsdaten

C [kN]	64,7
C ₀ [kN]	73,2
C _u [kN]	2,77
n _{th} [min ⁻¹]	2915
n _g [min ⁻¹]	5300
f ₀	16,3