

# 618/1000M

Rillenkugellager (einreihig, metrisch)



## Details:

### Hauptabmessungen

d [mm]	1000	d <sub>1</sub> [mm]	≈
D [mm]	1220		1070,6
B [mm]	100	D <sub>1</sub> [mm]	≈
Gewicht [kg]	≈ 248		1150,6
		r <sub>1,2</sub> [mm]	6

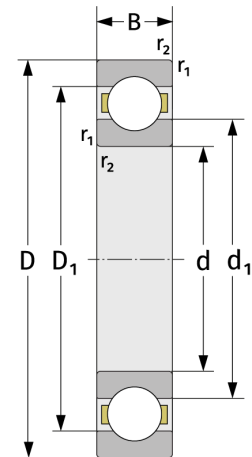
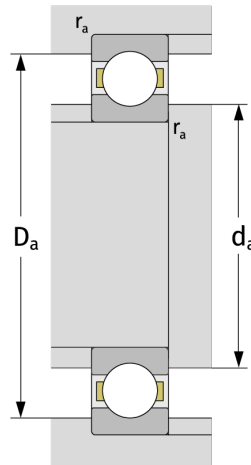

### Anschlussmaße

d <sub>a,min</sub> [mm]	1023
D <sub>a,max</sub> [mm]	1197
r <sub>a,max</sub> [mm]	5

### Berechnungsdaten

C [kN]	745
C <sub>0</sub> [kN]	1920
C <sub>u</sub> [kN]	27,9
n <sub>th</sub> [min <sup>-1</sup> ]	499
n <sub>g</sub> [min <sup>-1</sup> ]	610
f <sub>0</sub>	15,8