

618/850M

Rillenkugellager (einreihig, metrisch)



Details:

Hauptabmessungen			
d [mm]	850	d ₁ [mm]	≈ 906,5
D [mm]	1030	D ₁ [mm]	≈ 974,5
B [mm]	82	r _{1,2} [mm]	5
Gewicht [kg]	≈ 141		

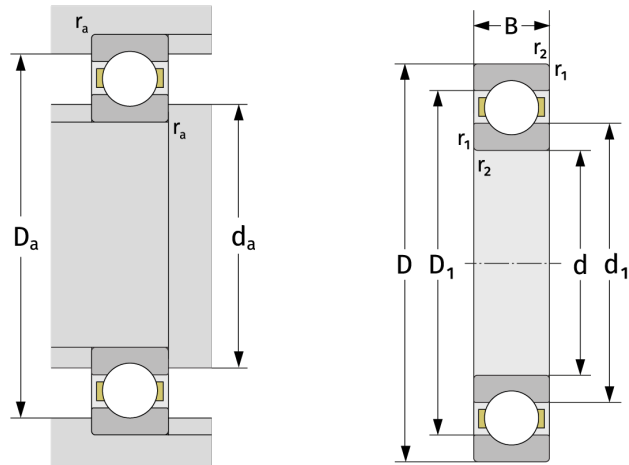

Anschlussmaße		Berechnungsdaten	
d _{a,min} [mm]	868	C [kN]	595
D _{a,max} [mm]	1012	C ₀ [kN]	1390
r _{a,max} [mm]	4	C _u [kN]	22
		n _{th} [min ⁻¹]	586
		n _g [min ⁻¹]	770
		f ₀	15,8