

61828M

Rillenkugellager (einreihig, metrisch)



Details:

Hauptabmessungen			
d [mm]	140	d ₁ [mm]	≈ 151,1
D [mm]	175	D ₁ [mm]	≈ 164,1
B [mm]	18	r _{1,2} [mm]	1,1
Gewicht [kg]	≈ 0,983		

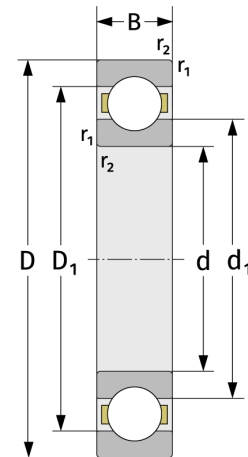
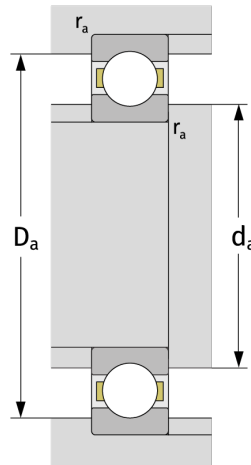

Anschlussmaße		Berechnungsdaten	
d _{a,min} [mm]	146	C [kN]	39,3
D _{a,max} [mm]	169	C ₀ [kN]	46,1
r _{a,max} [mm]	1	C _u [kN]	1,87
		n _{th} [min ⁻¹]	3342
		n _g [min ⁻¹]	6100
		f ₀	16