

# 619/1000M

Rillenkugellager (einreihig, metrisch)



## Details:

Hauptabmessungen			
d [mm]	1000	d <sub>1</sub> [mm]	≈ 1102,9
D [mm]	1320	D <sub>1</sub> [mm]	≈ 1218,9
B [mm]	140	r <sub>1,2</sub> [mm]	7,5
Gewicht [kg]	≈ 533		

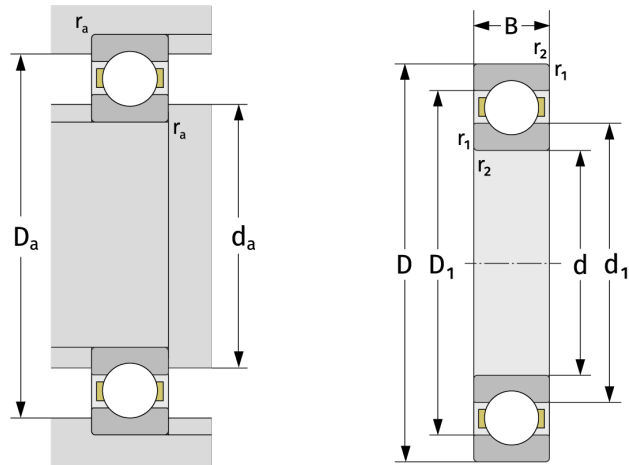

Anschlussmaße		Berechnungsdaten	
d <sub>a,min</sub> [mm]	1028	C [kN]	1110
D <sub>a,max</sub> [mm]	1292	C <sub>0</sub> [kN]	3040
r <sub>a,max</sub> [mm]	6	C <sub>u</sub> [kN]	43,3
		n <sub>th</sub> [min <sup>-1</sup> ]	494
		n <sub>g</sub> [min <sup>-1</sup> ]	570
		f <sub>0</sub>	16,3