

61944M

Rillenkugellager (einreihig, metrisch)



Details:

Hauptabmessungen			
d [mm]	220	d ₁ [mm]	≈ 245,2
D [mm]	300	D ₁ [mm]	≈ 275,2
B [mm]	38	r _{1,2} [mm]	2,1
Gewicht [kg]	≈ 7,96		

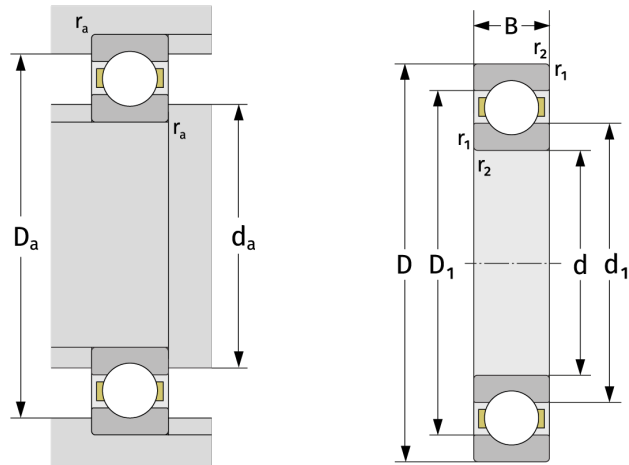

Anschlussmaße		Berechnungsdaten	
d _{a,min} [mm]	230	C [kN]	152
D _{a,max} [mm]	290	C ₀ [kN]	178
r _{a,max} [mm]	2,1	C _u [kN]	5,55
		n _{th} [min ⁻¹]	2640
		n _g [min ⁻¹]	3600
		f ₀	16,5