

# 6252M

Rillenkugellager (einreihig, metrisch)



## Details:

### Hauptabmessungen

d [mm]	260	d <sub>1</sub> [mm]	≈ 336,5
D [mm]	480	D <sub>1</sub> [mm]	≈ 404,5
B [mm]	80	r <sub>1,2</sub> [mm]	5
Gewicht [kg]	≈ 69,1		

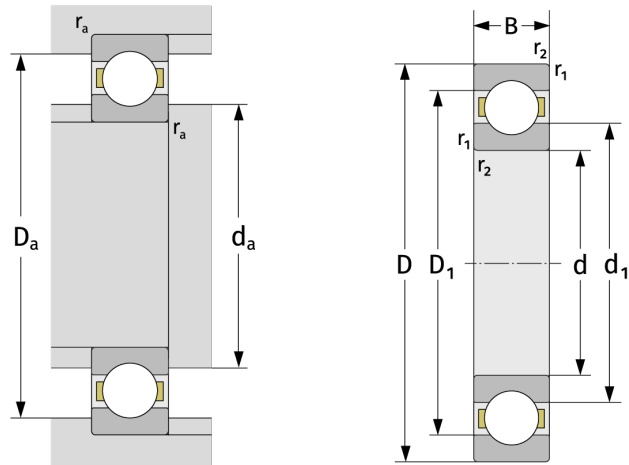

### Anschlussmaße

d <sub>a,min</sub> [mm]	280
D <sub>a,max</sub> [mm]	460
r <sub>a,max</sub> [mm]	4

### Berechnungsdaten

C [kN]	392
C <sub>0</sub> [kN]	535
C <sub>u</sub> [kN]	13,8
n <sub>th</sub> [min <sup>-1</sup> ]	1832
n <sub>g</sub> [min <sup>-1</sup> ]	2500
f <sub>0</sub>	15,2