

6444M

Rillenkugellager (einreihig, metrisch)



Details:

Hauptabmessungen

d [mm]	220	d ₁ [mm]	≈ 327,3
D [mm]	540	D ₁ [mm]	≈ 434,4
B [mm]	115	r _{1,2} [mm]	6
Gewicht [kg]	≈ 150		

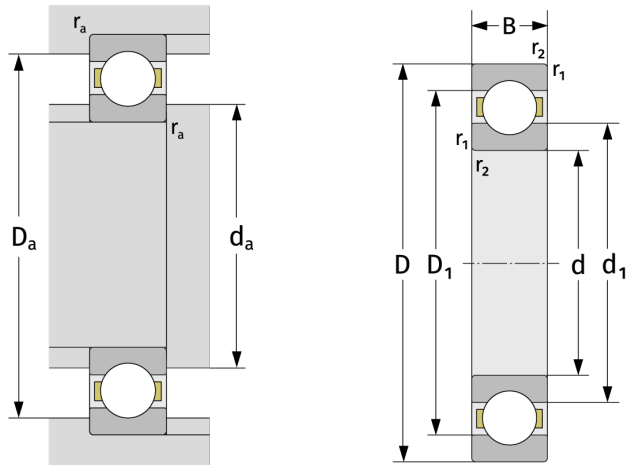

Anschlussmaße

d _{a,min} [mm]	250
D _{a,max} [mm]	510
r _{a,max} [mm]	5

Berechnungsdaten

C [kN]	570
C ₀ [kN]	780
C _u [kN]	19,9
n _{th} [min ⁻¹]	1830
n _g [min ⁻¹]	2400
f ₀	13,4