

# 7080MP

Schrägkugellager (einreihig, metrisch)



## Details:

### Hauptabmessungen

d [mm]	400	$D_1$ [mm]	$\approx 527,3$
D [mm]	600	$r_{1,2}$ [mm]	5
B [mm]	90	$r_{3,4}$ [mm]	2
Gewicht [kg]	$\approx 86,2$	$\alpha_0$ [°]	30
$d_1$ [mm]	$\approx 478,5$	a [mm]	$\approx 189$

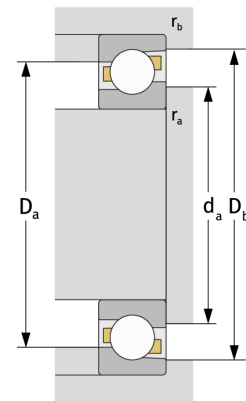
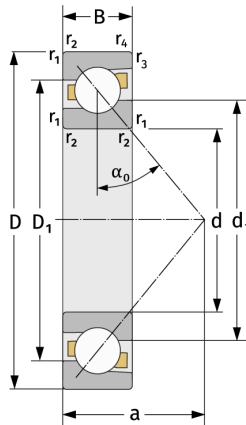

Anschlussmaße		Berechnungsdaten	
$d_{a, \min}$ [mm]	418	C [kN]	605
$D_{a, \max}$ [mm]	582	$C_0$ [kN]	1180
$D_{b, \max}$ [mm]	591,2	$C_u$ [kN]	26
$r_{a, \max}$ [mm]	4	$n_{th}$ [min <sup>-1</sup> ]	974
$r_{b, \max}$ [mm]	2	$n_g$ [min <sup>-1</sup> ]	1200