

71856MP

Schrägkugellager (einreihig, metrisch)



Details:

Hauptabmessungen

d [mm]	280	D_1 [mm]	$\approx 328,4$
D [mm]	350	$r_{1,2}$ [mm]	2
B [mm]	33	$r_{3,4}$ [mm]	1
Gewicht [kg]	$\approx 6,67$	α_0 [°]	30
d_1 [mm]	$\approx 303,6$	a [mm]	≈ 107

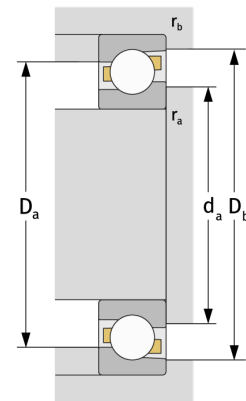
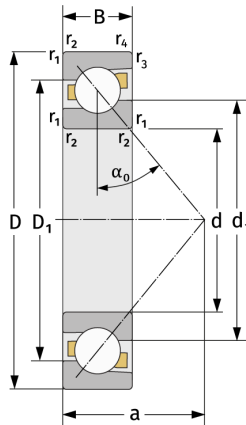

Anschlussmaße		Berechnungsdaten	
$d_{a, \min}$ [mm]	288,8	C [kN]	171
$D_{a, \max}$ [mm]	341,2	C_0 [kN]	259
$D_{b, \max}$ [mm]	345,4	C_u [kN]	7,31
$r_{a, \max}$ [mm]	2	n_{th} [min ⁻¹]	1526
$r_{b, \max}$ [mm]	1	n_g [min ⁻¹]	2100