

71976MP

Schrägkugellager (einreihig, metrisch)



Details:

Hauptabmessungen

d [mm]	380	D_1 [mm]	$\approx 476,7$
D [mm]	520	$r_{1,2}$ [mm]	4
B [mm]	65	$r_{3,4}$ [mm]	1,5
Gewicht [kg]	$\approx 37,7$	α_0 [°]	30
d_1 [mm]	$\approx 427,2$	a [mm]	≈ 162

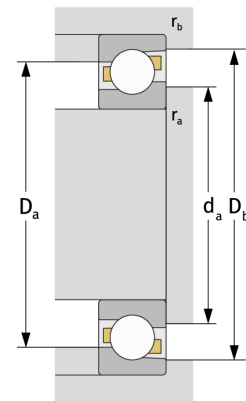
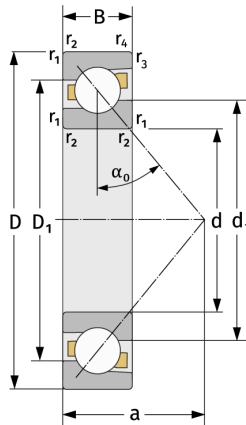

Anschlussmaße		Berechnungsdaten	
$d_{a, \min}$ [mm]	394,6	C [kN]	416
$D_{a, \max}$ [mm]	505,4	C_0 [kN]	760
$D_{b, \max}$ [mm]	513	C_u [kN]	17,8
$r_{a, \max}$ [mm]	3	n_{th} [min ⁻¹]	1072
$r_{b, \max}$ [mm]	1,5	n_g [min ⁻¹]	1400