

# 7284B.MP

Schrägkugellager (einreihig, metrisch)



## Details:

### Hauptabmessungen

d [mm]	420	$D_1$ [mm]	$\approx 628,5$
D [mm]	760	$r_{1,2}$ [mm]	7,5
B [mm]	109	$r_{3,4}$ [mm]	4
Gewicht [kg]	$\approx 226$	$\alpha_0$ [°]	40
$d_1$ [mm]	$\approx 559,6$	a [mm]	$\approx 302$

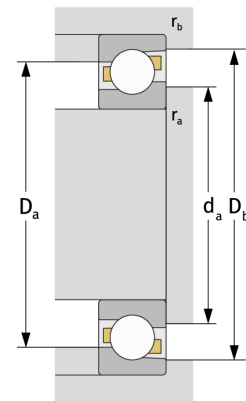
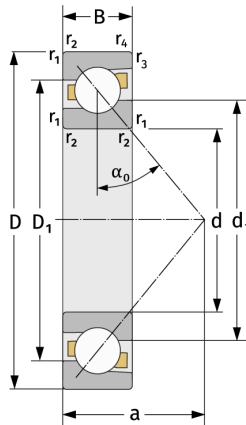

Anschlussmaße		Berechnungsdaten	
$d_{a, \min}$ [mm]	452	C [kN]	800
$D_{a, \max}$ [mm]	728	$C_0$ [kN]	1690
$D_{b, \max}$ [mm]	743	$C_u$ [kN]	34,3
$r_{a, \max}$ [mm]	6	$n_{th}$ [min <sup>-1</sup> ]	791
$r_{b, \max}$ [mm]	3	$n_g$ [min <sup>-1</sup> ]	980