

# 7292B.MP

Schrägkugellager (einreihig, metrisch)



## Details:

### Hauptabmessungen

d [mm]	460	$D_1$ [mm]	$\approx 688,1$
D [mm]	830	$r_{1,2}$ [mm]	7,5
B [mm]	118	$r_{3,4}$ [mm]	4
Gewicht [kg]	$\approx 293$	$\alpha_0$ [°]	40
$d_1$ [mm]	$\approx 611$	a [mm]	$\approx 330$

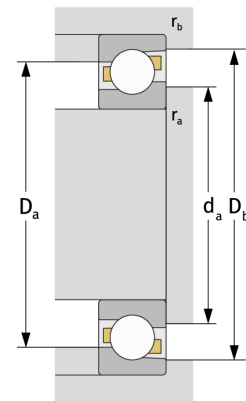
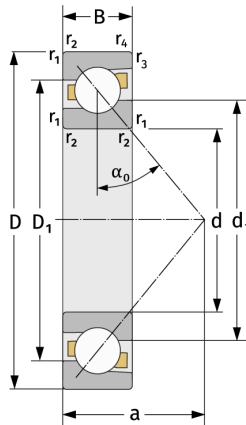

Anschlussmaße		Berechnungsdaten	
$d_{a, \min}$ [mm]	492	C [kN]	945
$D_{a, \max}$ [mm]	798	$C_0$ [kN]	2120
$D_{b, \max}$ [mm]	813	$C_u$ [kN]	41
$r_{a, \max}$ [mm]	6	$n_{th}$ [min <sup>-1</sup> ]	689
$r_{b, \max}$ [mm]	3	$n_g$ [min <sup>-1</sup> ]	880