

7296B.MP

Schrägkugellager (einreihig, metrisch)



Details:

Hauptabmessungen

d [mm]	480	D_1 [mm]	≈ 721
D [mm]	870	$r_{1,2}$ [mm]	7,5
B [mm]	125	$r_{3,4}$ [mm]	4
Gewicht [kg]	≈ 343	α_0 [°]	40
d_1 [mm]	$\approx 638,7$	a [mm]	≈ 346

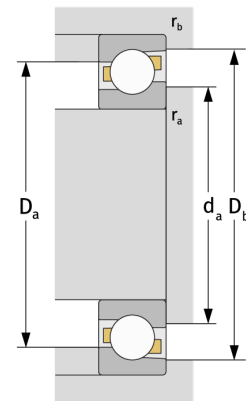
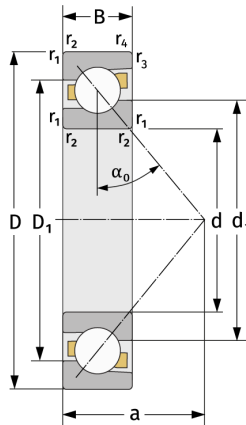

Anschlussmaße		Berechnungsdaten	
$d_{a, \min}$ [mm]	512	C [kN]	1040
$D_{a, \max}$ [mm]	838	C_0 [kN]	2400
$D_{b, \max}$ [mm]	853	C_u [kN]	45,4
$r_{a, \max}$ [mm]	6	n_{th} [min ⁻¹]	644
$r_{b, \max}$ [mm]	3	n_g [min ⁻¹]	830