

7376B.MP

Schrägkugellager (einreihig, metrisch)



Details:

Hauptabmessungen

d [mm]	380	D_1 [mm]	$\approx 628,9$
D [mm]	780	$r_{1,2}$ [mm]	7,5
B [mm]	128	$r_{3,4}$ [mm]	4
Gewicht [kg]	≈ 309	α_0 [°]	40
d_1 [mm]	$\approx 541,4$	a [mm]	≈ 307

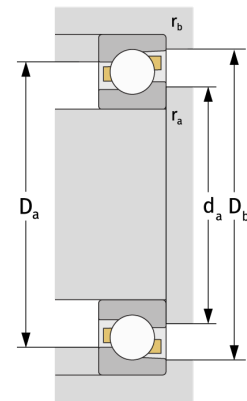
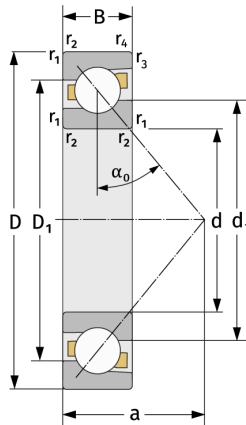

Anschlussmaße		Berechnungsdaten	
$d_{a, \min}$ [mm]	412	C [kN]	1010
$D_{a, \max}$ [mm]	748	C_0 [kN]	2060
$D_{b, \max}$ [mm]	763	C_u [kN]	42
$r_{a, \max}$ [mm]	6	n_{th} [min ⁻¹]	696
$r_{b, \max}$ [mm]	3	n_g [min ⁻¹]	1000