

AH240/530G

Abziehhülsen



Details:

Hauptabmessungen

d [mm]	530	G [mm]	Tr560x6
Gewicht [kg]	≈ 67,5	G ₁ [mm]	G1/4
d ₁ [mm]	500	l _{G1} [mm]	15
B ₁ [mm]	285	a [mm]	9
l _{G1} [mm]	35		

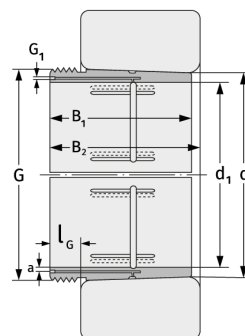

Anschlussmaße

Berechnungsdaten