

# AH32/530G

Abziehhülsen



## Details:

### Hauptabmessungen

d [mm]	530	G [mm]	Tr560x6
Gewicht [kg]	≈ 124	G <sub>1</sub> [mm]	G1/4
d <sub>1</sub> [mm]	500	l <sub>G1</sub> [mm]	15
B <sub>1</sub> [mm]	412	a [mm]	9
l <sub>G1</sub> [mm]	57		

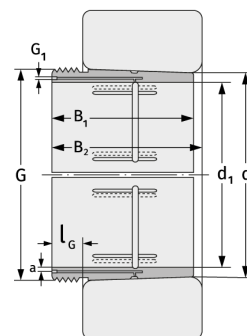

### Anschlussmaße

### Berechnungsdaten