

AH32/710A

Abziehhülsen



Details:

Hauptabmessungen

d [mm]	710	G [mm]	Tr760x7
Gewicht [kg]	≈ 282	G ₁ [mm]	G1/4
d ₁ [mm]	670	l _{G1} [mm]	15
B ₁ [mm]	515	a [mm]	9
l _{G1} [mm]	65		

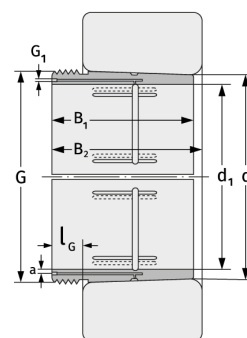

Anschlussmaße

Berechnungsdaten