

AH3276

Abziehhülsen



Details:

Hauptabmessungen

d [mm]	380	G [mm]	Tr420x5
Gewicht [kg]	≈ 45,6	G ₁ [mm]	G1/4
d ₁ [mm]	360	l _{G1} [mm]	15
B ₁ [mm]	284	a [mm]	9
l _{G1} [mm]	42		

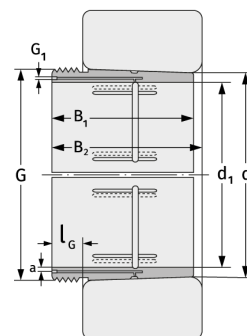

Anschlussmaße

Berechnungsdaten