

AH3964G

Abziehhülsen



Details:

Hauptabmessungen

d [mm]	320	G [mm]	Tr340x5
Gewicht [kg]	≈ 11,5	G ₁ [mm]	G1/4
d ₁ [mm]	300	l _{G1} [mm]	15
B ₁ [mm]	112	a [mm]	9
l _{G1} [mm]	21		

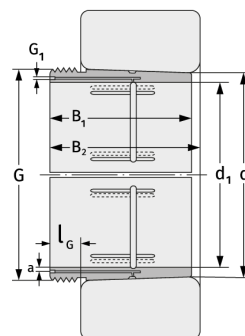

Anschlussmaße

Berechnungsdaten