

KML36

Nutmuttern



Details:

Hauptabmessungen			
Gewicht [kg]	≈ 1,95	B [mm]	27
		b [mm]	16
G [mm]	M180x 3	h [mm]	5
d ₁ [mm]	200		
d ₂ [mm]	210		

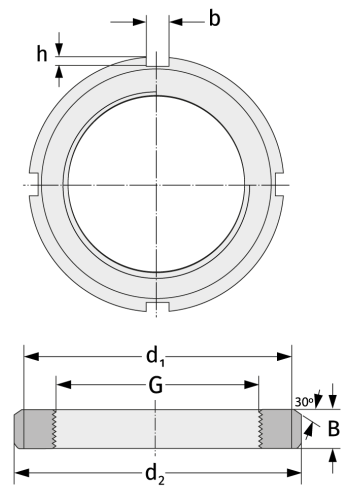

Anschlussmaße	Enthaltene Komponenten	
	Sicherung	MBL36