

Q2/500MPB

Vierpunktlager (metrisch)



Details:

Hauptabmessungen

d [mm]	500	D_1 [mm]	$\approx 758,7$
D [mm]	920	$r_{1,2}$ [mm]	7,5
B [mm]	136	α_0 [°]	23
Gewicht [kg]	≈ 460	a [mm]	≈ 301
d_1 [mm]	$\approx 661,3$		

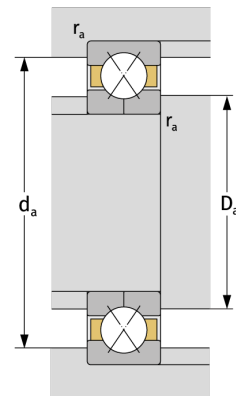
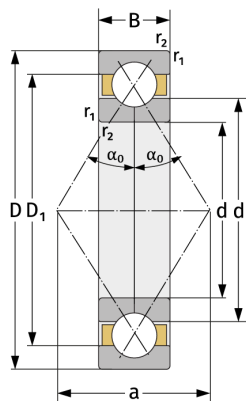

Anschlussmaße		Berechnungsdaten	
$d_{a, \min}$ [mm]	532	C [kN]	1920
$D_{a, \max}$ [mm]	888	C_0 [kN]	5500
$r_{a, \max}$ [mm]	6	C_u [kN]	103
		n_{th} [min ⁻¹]	426
		n_g [min ⁻¹]	1000