

# Q252MPB

Vierpunktlager (metrisch)



## Details:

### Hauptabmessungen

d [mm]	260	$D_1$ [mm]	$\approx 396,3$
D [mm]	480	$r_{1,2}$ [mm]	5
B [mm]	80	$\alpha_0$ [°]	23
Gewicht [kg]	$\approx 72,7$	a [mm]	$\approx 157$
$d_1$ [mm]	$\approx 343,7$		

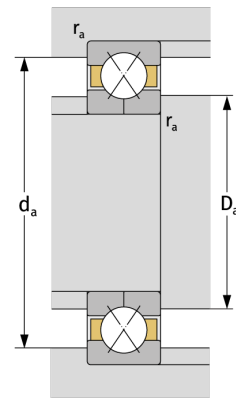
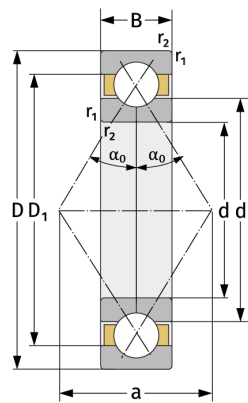

Anschlussmaße		Berechnungsdaten	
$d_{a, \min}$ [mm]	280	C [kN]	815
$D_{a, \max}$ [mm]	460	$C_0$ [kN]	1590
$r_{a, \max}$ [mm]	4	$C_u$ [kN]	40,9
		$n_{th}$ [min <sup>-1</sup> ]	1103
		$n_g$ [min <sup>-1</sup> ]	2200