

QJ10/500MPA

Vierpunktlager (metrisch)



Details:

Hauptabmessungen

d [mm]	500	D_1 [mm]	$\approx 642,5$
D [mm]	720	$r_{1,2}$ [mm]	6
B [mm]	100	α_0 [°]	35
Gewicht [kg]	≈ 146	a [mm]	≈ 427
d_1 [mm]	$\approx 577,5$		

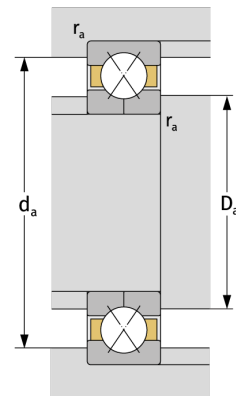
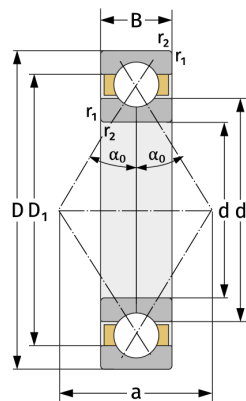

Anschlussmaße		Berechnungsdaten	
$d_{a, \min}$ [mm]	523	C [kN]	1110
$D_{a, \max}$ [mm]	697	C_0 [kN]	3010
$r_{a, \max}$ [mm]	5	C_u [kN]	61,1
		n_{th} [min ⁻¹]	581
		n_g [min ⁻¹]	1300